



Instinct Guides You



## Buxton Road, Weymouth £140,000

- Panoramic Sea Views
- No Onward Chain
- Allocated Parking
- Communal Garden
- On A Bus Route
- First Floor Apartment
- Close To Amenities
- Near Rodwell Trail



Registration No. 08079158 Directors Mr Wilson, Mr Tominey

Courtesy Notice Upon using WilsonTominey as selling agents ensure we are made aware of contractual obligations you may be under. We can then proceed accordingly.

WilsonTominey Ltd  
15 Westham Rd.  
DT4 8NS

T 01305 775500  
E sales@wilsontominey.co.uk  
W www.wilsontominey.co.uk



Situated in an elevated position along Buxton Road, this well proportioned apartment enjoys stunning panoramic sea views across Weymouth Bay and towards Portland, with the added benefit of allocated parking, a share of the communal garden and no onward chain. The property is conveniently located for access to local amenities, the town centre and seafront, while offering a peaceful setting with far reaching coastal outlooks.

The accommodation is accessed via a communal entrance with stairs rising to the apartment. Upon entering, a hallway provides access to all principal rooms. The lounge is positioned to the front of the property and takes full advantage of the elevated position, enjoying impressive sea views through a large window which fills the room with natural light. This room offers ample space for a range of living room furnishings.

Adjacent is the kitchen, fitted with a range of base and eye level units with work surfaces, incorporating space for appliances and a window allowing further light and ventilation.

The bedroom is a generous double room with built in storage and sufficient space for additional furnishings, also benefiting from a bright and airy feel. The bathroom is fitted with a bath with shower over, wash hand basin and WC, finished in a neutral style.

Externally, the property benefits from a shared communal garden, providing outdoor space to enjoy the surroundings and coastal views. The apartment also includes an allocated parking space, completing this appealing home in a sought after Weymouth location.



## Room Dimensions

**Lounge** 13'9" x 10'1" (4.21 x 3.09)

**Kitchen** 10'2" x 6'1" (3.1 x 1.87)

**Bedroom** 11'9" x 10'2" (3.59 x 3.1)

**Bathroom**

### Lease & Maintenance Information

The vendor informs us that there is a 999 year lease which commenced in 2021 with a share of the freehold, the service charge is to be arranged, no ground rent, no holiday letting or pets permitted.

We recommend these details are checked by a solicitor before incurring costs.

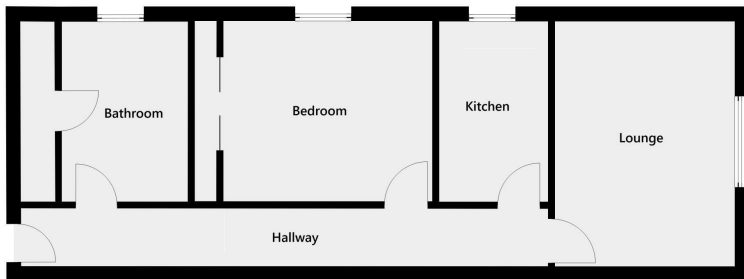

Energy Efficiency Rating		Current	Potential
Very energy efficient - lower running costs			
(92 plus) A			
(81-91) B			
(69-80) C			
(55-68) D			
(39-54) E			
(21-38) F			
(1-20) G			
Not energy efficient - higher running costs			
<b>England &amp; Wales</b>		EU Directive 2002/91/EC	

Environmental Impact (CO <sub>2</sub> ) Rating		Current	Potential
Very environmentally friendly - lower CO <sub>2</sub> emissions			
(92 plus) A			
(81-91) B			
(69-80) C			
(55-68) D			
(39-54) E			
(21-38) F			
(1-20) G			
Not environmentally friendly - higher CO <sub>2</sub> emissions			
<b>England &amp; Wales</b>		EU Directive 2002/91/EC	

Important Notice: Particulars are prepared for marketing purposes only and should not be treated as a statement of the condition of any building, fixture or appliance. All measurements, floor plans and lease/ maintenance are approximate and not to be relied upon. Purchasers should make their own checks before relying on any of the information provided herein. \* For double glazing and gas radiator heating, it is where specified.